



REDMANS ROAD, STEPNEY GREEN E1

£425,000 LH

- Chain Free
- Secure Gated Parking
- 25 ft Open Plan Social Space
- 999 Year Lease
- Own Private Entrance
- Ideal Starter Home

wj.
meade

Redmans Road

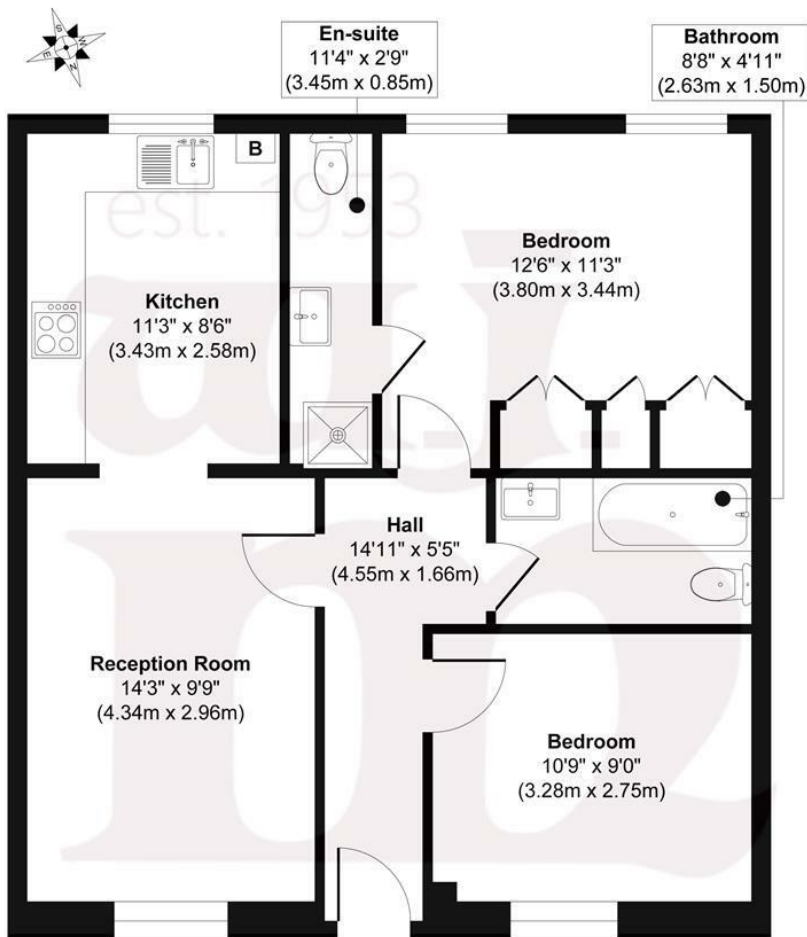

Ground Floor

Approx. Gross Internal Floor Area 634 sq. ft / 58.98 sq. m

Illustration for identification purposes only, measurements are approximate, not to scale.
Produced by Elements Property



WJ Meade are pleased to present this two double bedroom ground floor flat, part of a low rise gated development in Stepney Green. Arranged with dual aspect open plan kitchen to reception room, two well appointed bedrooms and two bathrooms including an en suite shower to master with access to a private communal garden . Situated close to Stepney Green tube and within easy reach of the various transport links and amenities at Whitechapel. This property is perfectly located for busy city professionals and healthcare staff. This flat is a short walk from Royal London Hospital offering unbeatable convenience in the heart of East London.

All sizes are approximate. The Agent has not tested any apparatus, equipment, fixtures and fittings, or services and so cannot verify that they are in working order or fit for the purpose. A buyer is advised to obtain verification from their Solicitors or Surveyor. Photographs are for illustration purposes only and may depict items, which are not for sale or included in the sale price. References to tenure of a property are based upon information supplied by the vendor. The agent has not had sight of the title documents, a buyer is advised to obtain verification from their solicitor. Money Laundering Regulations 2003: Intending purchasers will be asked to produce identification, documentation at a later stage and we would ask for your co-operation in order that there will be no delay in agreeing the sale.

These particulars are intended to give a fair description of the property only and are in no way guaranteed, nor do of any contract. They are issued on the express condition that all negotiations are conducted through W.J. Meade Estate Agents. All subject to contract and to being unsold.

Service charge £2,136.18 pa
Ground rent £0
975 years lease
Council Tax Band D
Current EPC Rating 77

